



Hillyfields, IG102PR

Asking Price £299,995 Leasehold



To view call **0208 504 2222**
Email buckhursthill@churchill-estates.co.uk



- Entrance hall
- Lounge
13'3"x11'7"
- Kitchen
11'8"x11'5"
- Bedroom 1
11'8"x10'8"
- Bedroom 2
13'3"x9'4"
- Bathroom
- Garden

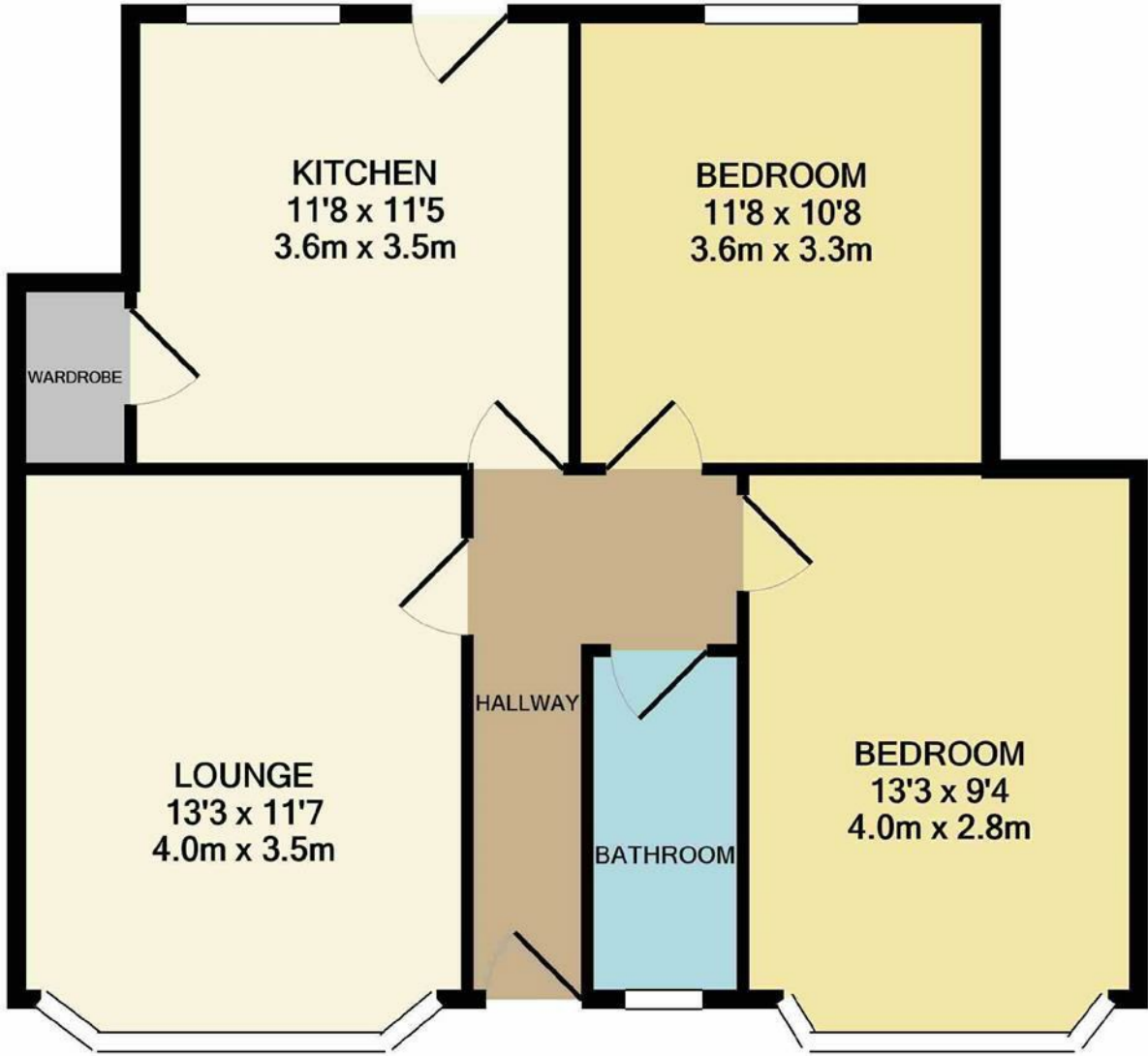

TOTAL APPROX. FLOOR AREA 683 SQ.FT. (63.4 SQ.M.)
PLAN NOT TO SCALE FOR INFORMATION ONLY
Made with Metropix ©2021

Energy Efficiency Rating		
	Current	Potential
Very energy efficient - lower running costs		
(92 plus) A		
(81-91) B		
(69-80) C		
(55-68) D		
(39-54) E		
(21-38) F		
(1-20) G		
Not energy efficient - higher running costs		
EU Directive 2002/91/EC		
England & Wales		

The Agent has not tested any apparatus, equipment, fixtures and fittings or services and so cannot verify that they are in working order or fit for the purpose. A buyer is advised to obtain verification from their solicitor or surveyor.
References to the tenure of a property are based on information supplied by the seller. The agent has not had the sight of the title documents. A buyer is advised to obtain verification from their solicitors.